

Prepared by the U.S. Geological Survey for publication by the Defense Mapping Agency Hydrographic/Topographic Center, Washington, D.C.  
 MAP INFORMATION AS OF 1982  
 Lithographed by DMAAC 11-87

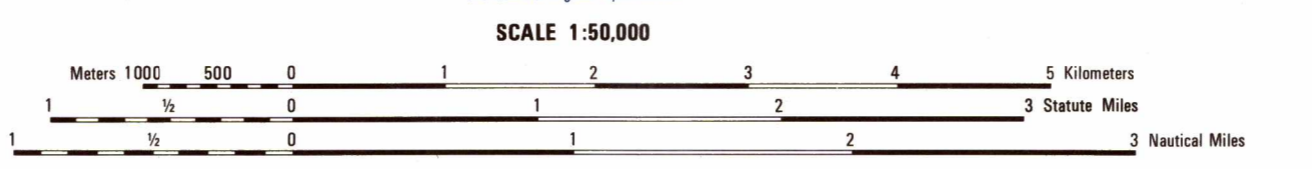

ELEVATIONS IN METERS  
 CONTOUR INTERVAL 20 METERS

SPHEROID: 1983  
 GRID: 1000-METER UTM ZONE 13 (BLACK NUMERED LINES)  
 PROJECTION: TRANSVERSE MERCATOR  
 VERTICAL DATUM: NATIONAL GEODETIC VERTICAL DATUM OF 1929  
 HORIZONTAL DATUM: 1987 NORTH AMERICAN DATUM  
 CONTROL: U.S. AND MEXICAN  
 PREPARED BY: U.S. GEOLOGICAL SURVEY  
 PUBLISHED BY: DMAAC 2-95

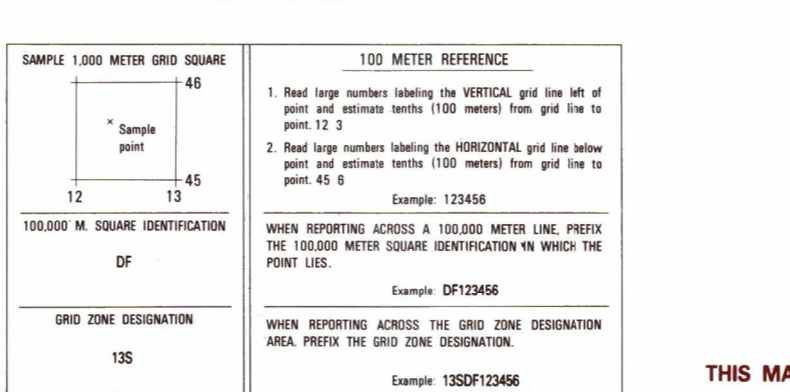

BOUNDARIES ADJOINING SHEETS

4848 II	4848 III	4848 III
4848 IV	4848 I	4848 IV
4848 II	4848 II	4848 II

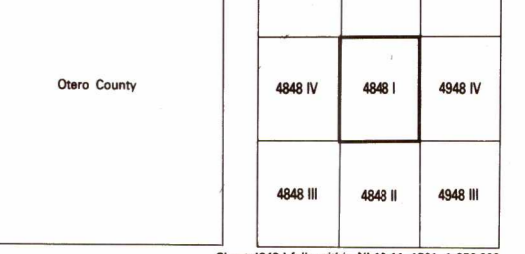

- ROADS**
- Divided highway with median strip
  - Primary, all weather, hard surface
  - Secondary, all weather, hard surface
  - Light duty, all weather, hard or improved surface
  - Fair or dry weather, unimproved surface
  - Trail
  - Route markers: Interstate, Federal, State
  - Bridge
  - RAILROADS (Standard gauge 1.44m. - 4'8 1/2")
  - National, with monument
  - State, with monument
  - Civil township, town
  - Incorporated city, village, town
  - Reservation: National, State, Military
- Power**
- Power transmission line
  - Structure
  - Chaucer: School
  - Power substation
  - Windmill, Watermill
  - Well: Tank
  - Mine shaft
  - Open pit mine or quarry
  - Horizontal control station
  - Bench mark, monumented
  - Bench mark, non-monumented
  - Spot elevations in meters
  - Leaves, rims, dikes
  - Bluffs, cliffs
  - Woodland
  - Scattered trees: Scrub
  - Vineyard: Orchard, plantation
  - Intermittent lake: Cham, Earthen, Masonry
  - Stream: Perennial, Intermittent
  - Marsh, swamp
  - Small falls; large falls
  - Small rapids; large rapids
- BOUNDARIES**
- National, with monument
  - State, with monument
  - Civil township, town
  - Incorporated city, village, town
  - Reservation: National, State, Military

