

V753, EDITION 3-AMS
 Prepared by the Army Map Service (LU), Corps of Engineers, U.S. Army, Washington, D.C.
 Compiled in 1966 from U.S. Quadrangles, Kentucky 1:24,000, USGS, Sheets Big Clifty, Summit,
 Howe Valley, Constantine, revised 1960 (reliability good). Horizontal and vertical control by
 USGS, USC&GS and C.E. This map complies with the national standard map accuracy require-
 ments. Map not field checked.

LEGEND

- ROAD DATA 1965**
 In developed areas, only through roads are classified
- Hard surface, heavy duty road, four or more lanes wide
 - Hard surface, heavy duty road, two lanes wide
 - Hard surface, medium duty road, four or more lanes wide
 - Hard surface, medium duty road, two lanes wide
 - Three lanes wide
 - Unimproved dirt road
 - Trail
 - Route markers: Interstate, Federal, State
 - Barricade, shed, greenhouse, stadium, etc.
 - Bench mark, non-monumented
 - Spot elevations in meters
 - Checked, unchecked
 - Light, lighthouse, windmill, wind pump, water mill
 - Woods or brushwood
 - Vineyard, Orchard
 - Intermittent lake
 - Marsh or swamp
 - Rapids, Falls
 - Large rapids; Large falls
- RAILROADS**
 Standard gauge
 Narrow gauge
 In street
 Outing
- BOUNDARIES**
 National
 State (with monument)
 County
 Township
 Corporate limits
 Military reservation
 Other reservation

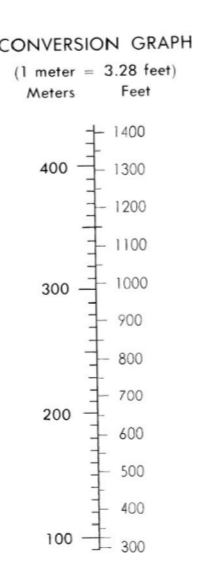

ELEVATIONS IN METERS

CONTOUR INTERVAL 10 METERS
 VERTICAL DATUM: SEA LEVEL DATUM 1929

TRANSVERSE MERCATOR PROJECTION

HORIZONTAL DATUM: 1927 NORTH AMERICAN DATUM

BLACK NUMBERED LINES INDICATE THE 1000 METER UNIVERSAL TRANSVERSE MERCATOR GRID, ZONE 16

USGS SHOULD REFER CORRECTIONS, ADDITIONS, AND COMMENTS TO THE NIMA CUSTOMER HELP DESK 1-800-455-0883 COMMERCIAL 1-314-250-1238 (DN 400-1238 OR WRITE TO ATTN: CDD MAIL STOP P-37 NATIONAL IMAGERY AND MAPPING AGENCY 4600 SANGAMORE ROAD BETHESDA MD 20815-5003)

GRID ZONE DESIGNATION: 16S

100,000 M. SQUARE IDENTIFICATION

ES

TO GIVE A STANDARD REFERENCE ON THIS SHEET TO NEAREST 100 METERS

SAMPLE POINT: SUITEZ CREEK CHURCH

1. Read letters identifying 100,000 meter square in which the point lies:
 2. Locate first VERTICAL grid line to LEFT of point and read LARGE figure labeling the line either in the top or bottom margin, or as the line itself.
 3. Locate first HORIZONTAL grid line BELOW point and read LARGE figure labeling the line either in the left or right margin, or as the line itself.
 Estimate meters from grid line to point.

SAMPLE REFERENCE: E576646
 If reporting beyond 10° in any direction, prefix Grid Zone Designation, as:
 16S576646

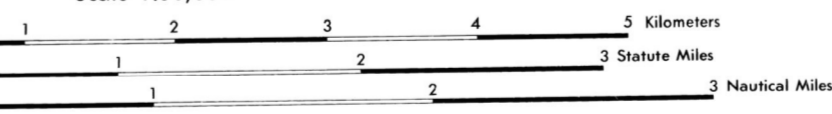

ELEVATION GUIDE

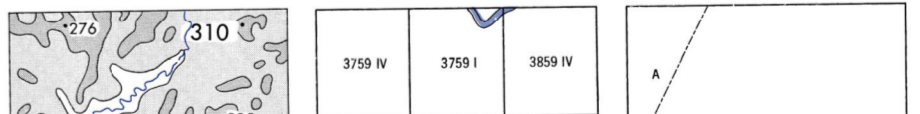

ADJOINING SHEETS

3759 IV	3759 I	3859 IV
3759 III	3759 II	3859 III
3758 IV	3758 I	3858 IV

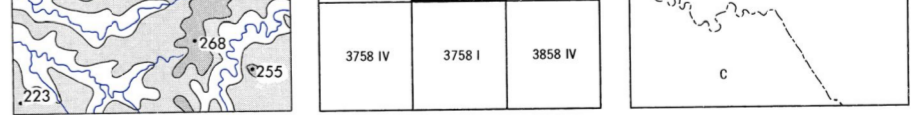

GRID CONVERGENCE 1° 21' 00" WEST FOR CENTER OF SHEET

TO CONVERT A MAGNETIC AZIMUTH TO A GRID AZIMUTH
 ADD G-M ANGLE

TO CONVERT A GRID AZIMUTH TO A MAGNETIC AZIMUTH
 SUBTRACT G-M ANGLE

NSN 7643014043941
 NIMA Ref No. V753X37592

FOR SALE BY U.S. GEOLOGICAL SURVEY, RESTON, VIRGINIA 22092
 METRIC CONVERSIONS OF CONTOURS AND ELEVATIONS 1978
 THIS MAP IS REDLIGHT READABLE
BIG CLIFTY, KENTUCKY