

Prepared by the U.S. Geological Survey for publication by the Defense Mapping Agency Hydrographic/Topographic Center, Washington, D.C.
MAP INFORMATION AS OF 1988.

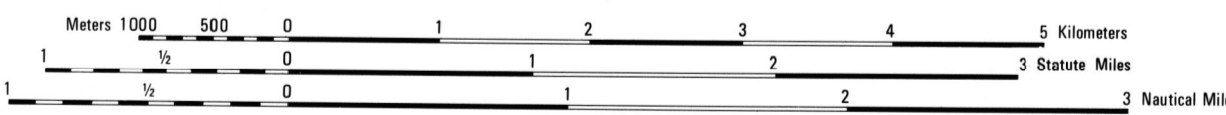

ELEVATIONS IN METERS
CONTOUR INTERVAL 5 METERS

ELLIPSOID: CLARKE 1866
GRID: 1,000-METER UTM ZONE 17 (BLACK NUMBERED LINES)
10,000-FOOT STATE GRID TICS, GEORGIA (EAST ZONES)
FLORIDA (NORTH AND EAST ZONES)
PROJECTION: TRANSVERSE MERCATOR
VERTICAL DATUM: NATIONAL GEODETIC VERTICAL DATUM OF 1929
HORIZONTAL DATUM: 1907 NORTH AMERICAN DATUM
CONTROL BY: USGS, NOS/NOAA, AND USACE
PREPARED BY: U.S. GEOLOGICAL SURVEY

FOR SALE BY U.S. GEOLOGICAL SURVEY
DENVER, COLORADO 80225, OR RESTON, VIRGINIA 22092

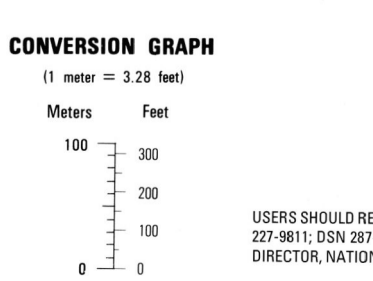
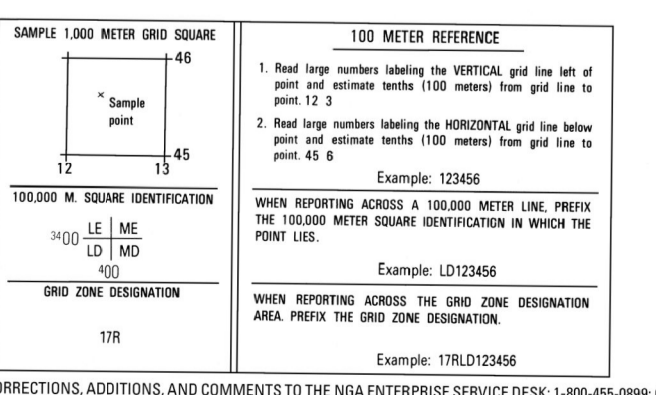

LEGEND

CAUTION: ALL TELEPHONE AND ELECTRIC SERVICE LINES ARE NOT SHOWN.
A LANE ON THIS MAP IS CONSIDERED TO BE 25 METERS WIDE.
IN DEVELOPED AREAS ONLY THROUGH ROADS ARE CLASSIFIED.
THERE MAY BE PRIVATE INHOLDINGS WITHIN THE BOUNDARIES OF THE NATIONAL OR STATE RESERVATIONS SHOWN ON THIS MAP.

- ROADS: Divided highway with median strip, Primary, all weather, hard surface, Secondary, all weather, hard surface, Fair or dry weather, unimproved surface, Trail, Route markers: Interstate, Federal, State, Railroad station: Location known, Location unknown, Car line, Railroad bridge, Tunnel: Highway, Railroad
- RAILROADS: Standard gauge 1.44m - 4'8 1/2", Single track, Multiple track, Nonoperating
- BOUNDARIES: National, with monument, State, territory, County, parish, Civil township, town, Incorporated city, village, town, Reservation: National, State, Military
- Buildings, Structures, Church, School, Power substation, Windmill, Watermill, Well, Tank, Mine shaft, Open pit mine or quarry, Helicopter landing station, Bench mark, monumented, Bench mark, non-monumented, Spot elevations in meters, Levees, dikes, Bluffs, cliffs, Woodland, Scattered trees, Scrub, Vineyard, Orchard, plantation, Intermittent lake: Dam, Earthen, Masonry, Stream, Perennial, Intermittent, Marsh, swamp, Small falls, Large falls, Small rapids, Large rapids
- Power transmission line, Buildings, Structures, Church, School, Power substation, Windmill, Watermill, Well, Tank, Mine shaft, Open pit mine or quarry, Helicopter landing station, Bench mark, monumented, Bench mark, non-monumented, Spot elevations in meters, Levees, dikes, Bluffs, cliffs, Woodland, Scattered trees, Scrub, Vineyard, Orchard, plantation, Intermittent lake: Dam, Earthen, Masonry, Stream, Perennial, Intermittent, Marsh, swamp, Small falls, Large falls, Small rapids, Large rapids

USGS 30082-E1-TM-050

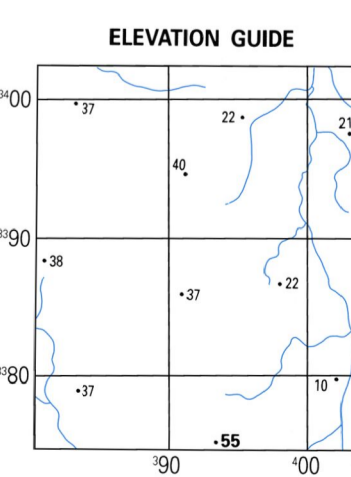
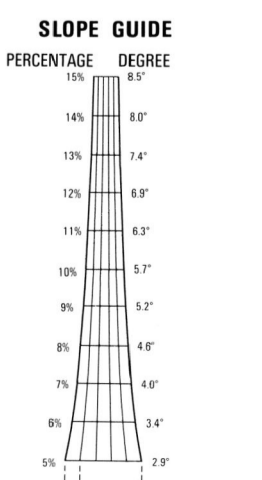
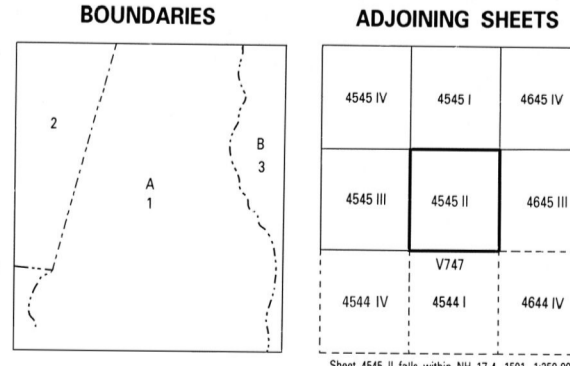

THIS MAP IS RED-LIGHT READABLE