

ELEVATIONS IN METERS
CONTOUR INTERVAL 20 METERS

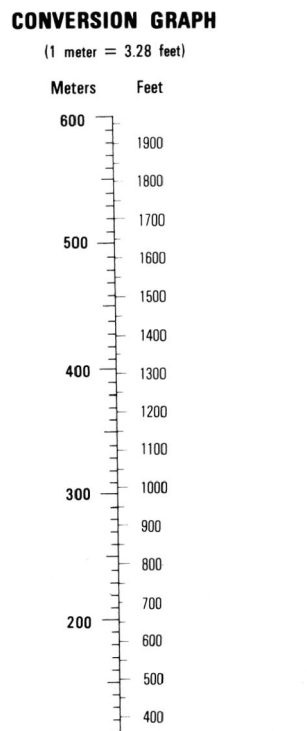

100 METER REFERENCE
FOR SALE BY U.S. GEOLOGICAL SURVEY
DENVER, COLORADO 80226, OR RESTON, VIRGINIA 22092

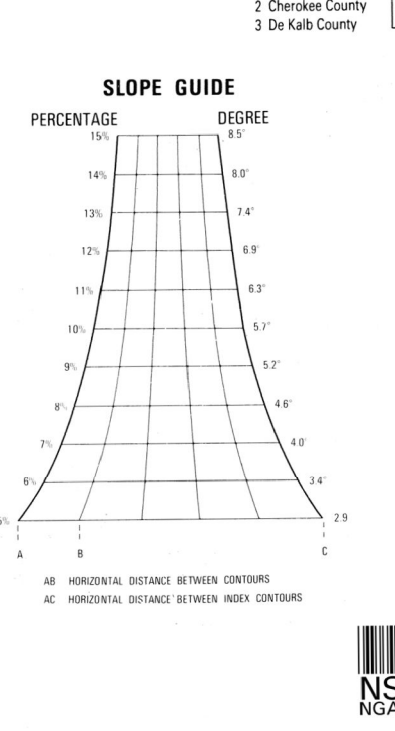
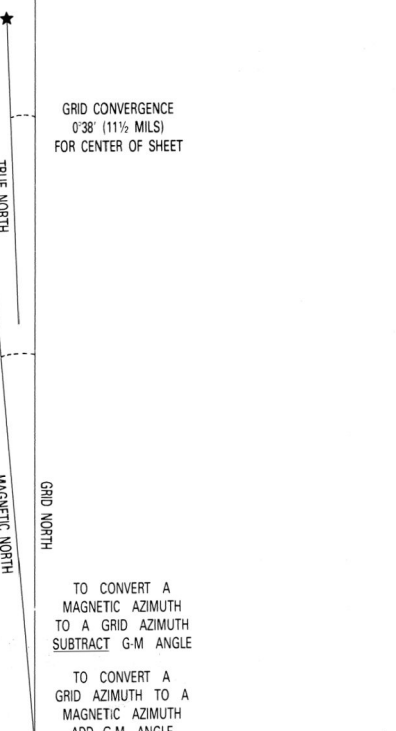

BOUNDARIES ADJOINING SHEETS

3852 I	3852 II	3852 III	3852 IV
3851 I	3851 II	3851 III	3851 IV

Prepared by the U.S. Geological Survey for publication by the Defense Mapping Agency

MAP INFORMATION AS OF 1987-88

LEGEND

CAUTION: ALL TELEPHONE AND ELECTRIC SERVICE LINES ARE NOT SHOWN.

A LANE ON THIS MAP IS CONSIDERED TO BE 2.5 METERS WIDE.

IN DEVELOPED AREAS ONLY THROUGH ROADS ARE CLASSIFIED.

THERE MAY BE PRIVATE ENCLAVES WITHIN THE BOUNDARIES OF THE NATIONAL OR STATE RESERVATIONS SHOWN ON THIS MAP.

ROADS

- Divided highway with median strip
- Primary, all weather, hard surface
- Secondary, all weather, hard surface
- Light duty, all weather, hard or improved surface
- Fair or dry weather, unimproved surface
- Trail
- Route markers: Interstate, Federal, State
- BRIDGES (Standard gauge 1.43m - 4'8 1/2")
- Single track
- Multiple track
- Nonoperating
- Railroad station: Location known; Location unknown
- Car line
- Railroad bridge
- Tunnel: Highway; Railroad

BOUNDARIES

- National, with monument
- State, territory
- County, parish
- Civil township, town
- Incorporated city, village, town
- Reservation: National; State; Military

Buildings

- Power transmission line
- Structures
- Church: School
- Power substation
- Windmill; Watermill
- Well; Tank
- Mine shaft
- Open pit mine or quarry
- Horizontal control station
- Bench mark, monument
- Bench mark, non-monumented
- Spot elevations in meters
- Levers, rims, dikes
- Bluffs, cliffs
- Woodland
- Scattered trees: Scrub
- Vineyard; Orchard; plantation
- Intermittent lake: Dam; Earthen; Masonry
- Stream: Perennial; Intermittent
- Marsh: Swamp
- Small falls; Large falls
- Small rapids; Large rapids

CONVERSION GRAPH

(1 meter = 3.28 feet)

Meters: 0, 100, 200, 300, 400, 500, 600

Feet: 0, 100, 200, 300, 400, 500, 600

ELLIPSOID CLARKE 1866
GRID 100,000 FOOT STATE GRID (ALABAMA EAST ZONE)
PROJECTION TRANSVERSE MERCATOR
VERTICAL DATUM NATIONAL GEODETIC DATUM OF 1929
HORIZONTAL DATUM 1825 NORTH AMERICAN DATUM
CONTROL U.S. GEODETIC SURVEY
PREPARED BY U.S. GEOLOGICAL SURVEY
PUBLISHED BY DMA 8-95

Reprinted by NGA 08-05
FOR SALE BY U.S. GEOLOGICAL SURVEY
DENVER, COLORADO 80226, OR RESTON, VIRGINIA 22092

100 METER REFERENCE

1. Read large numbers labeling the VERTICAL grid line to the left of the point and estimate tenths (100 meters) from grid line to point. Example: 123.45

2. Read large numbers labeling the HORIZONTAL grid line below the point and estimate tenths (100 meters) from grid line to point. Example: 56.78

WHEN REPORTING ACROSS A 100,000 METER LINE, PRINT THE FOLLOWING METER SQUARE IDENTIFICATION IN WHICH THE POINT LIES. Example: FN123456

WHEN REPORTING ACROSS A GRID ZONE DESIGNATION AREA, PRINT THE GRID ZONE DESIGNATION. Example: 18S FN123456

USERS SHOULD REFER TO CORRECTIONS, ADDITIONS, AND COMMENTS TO THE NGA OPERATIONAL HELP DESK: 1-800-455-8899, COMMERCIAL 314-263-4868, DSN 693-4864, OR WRITE TO: DIRECTOR, NATIONAL GEOSPATIAL-INTELLIGENCE AGENCY, ATTN: ES, MAIL STOP 1-98, 4800 SANGAMINE ROAD, BETHESDA, MD 20815-5002.