

Prepared by the U.S. Geological Survey for publication by the Defense Mapping Agency

MAP INFORMATION AS OF 1985-1987.

LEGEND

CAUTION: ALL TELEPHONE AND ELECTRIC SERVICE LINES ARE NOT SHOWN.

A LANE ON THIS MAP IS CONSIDERED TO BE 2.5 METERS WIDE.

IN DEVELOPED AREAS ONLY THROUGH ROADS ARE CLASSIFIED.

THERE MAY BE PRIVATE INCLUSIONS WITHIN THE BOUNDARIES OF THE NATIONAL OR STATE RESERVATIONS SHOWN ON THIS MAP.

- ROADS: Divided highway with median strip, Primary all weather, hard surface, Secondary, all weather, hard surface, Light duty, all weather, hard or improved surface, Fair or dry weather, unpaved surface, Trail, Route markers: Interstate, Federal, State, Bridge, RAILROADS (Standard gauge 1.44m - 4'8 1/2"), Single track, Multiple track, Nonoperating, Railroad station: Location known, Location unknown, Car line, Tunnel: Highway, Railroad, Boundaries: National, with monument, State, territory, County, parish, Civil township, town, Incorporated city, village, town, Reservation: National, State, Military

CONVERSION GRAPH

(1 meter = 3.28 feet)

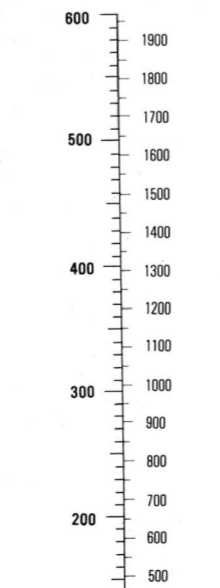

ELEVATIONS IN METERS

CONTOUR INTERVAL 20 METERS

ELLIPSOID: CLARKE 1866, 1,000 METER UTM ZONE 18 (BLACK NUMBERED LINES), 10,000 FOOT STATE GRID TICS, ALABAMA (EAST ZONE), PROJECTION: TRANSVERSE MERCATOR, VERTICAL DATUM: NATIONAL GEODETIC VERTICAL DATUM OF 1929, HORIZONTAL DATUM: 1927 NORTH AMERICAN DATUM, CONTROL BY: USGS, NOS/NOAA, USCE AND ALABAMA POWER COMPANY, PREPARED BY: U.S. GEOLOGICAL SURVEY, PUBLISHED BY: DMA 8-95, Reprinted by NGA 2-08

FOR SALE BY U.S. GEOLOGICAL SURVEY, DENVER, COLORADO 80225 OR RESTON, VIRGINIA 22092

100 METER REFERENCE: Includes a diagram of a 100m grid square and instructions on how to use it for elevation identification. Example: FN123456.

USERS SHOULD REFER TO CORRECTIONS, ADDITIONS, AND COMMENTS TO THE NGA OPERATIONAL HELP DESK: 1-800-455-0899; COMMERCIAL 314-353-4884; USN 163-4864 OR WRITE TO: DIRECTOR, NATIONAL GEOGRAPHIC INTELLIGENCE AGENCY, ATTENTION: MAIL STOP L-68, 4600 SANGAMORE ROAD, BETHESDA, MD 20816-5003.

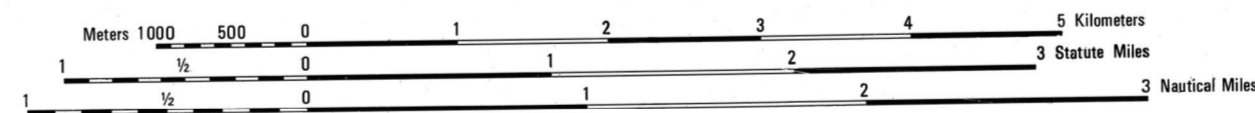

BOUNDARIES

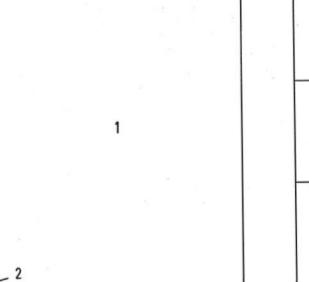

ADJOINING SHEETS

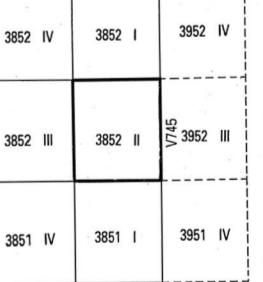

SLOPE GUIDE

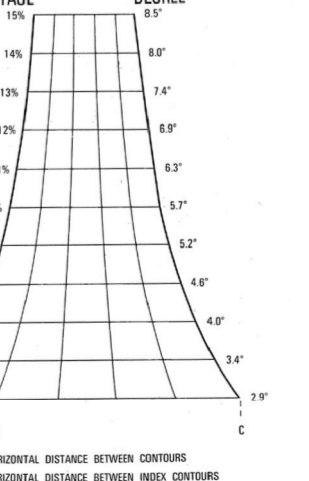

ELEVATION GUIDE

