

Prepared by the U.S. Geological Survey for publication by the Defense Mapping Agency Hydrographic/Topographic Center, Washington, D.C.  
MAP INFORMATION AS OF 1985.

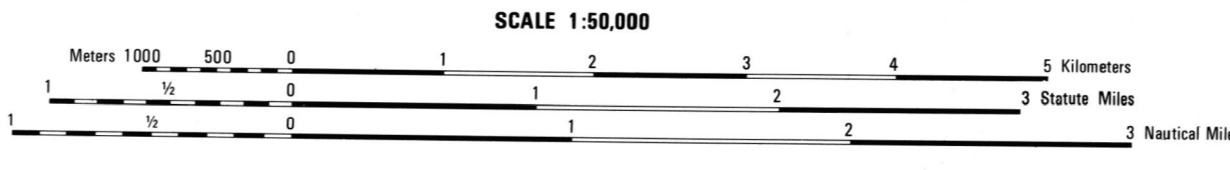

ELEVATIONS IN METERS

CONTOUR INTERVAL 20 METERS

ELLIPSOID: CLARKE 1866  
1,000-METER UTM ZONE 18 (BLACK NUMBERED LINES)  
10,000-FOOT STATE GRID TEXAS ALABAMA (WEST ZONE) AND MISSISSIPPI (EAST ZONE)  
PROJECTION: TRANSVERSE MERCATOR  
VERTICAL DATUM: NATIONAL GEODETIC DATUM OF 1929  
HORIZONTAL DATUM: 1927 NORTH AMERICAN DATUM  
CONTROLLING: U.S. AND FOREIGN  
PREPARED BY: U.S. GEOLOGICAL SURVEY

Reprint by NIMA 01-00  
FOR SALE BY U.S. GEOLOGICAL SURVEY  
DENVER, COLORADO 80225, OR RESTON, VIRGINIA 20192

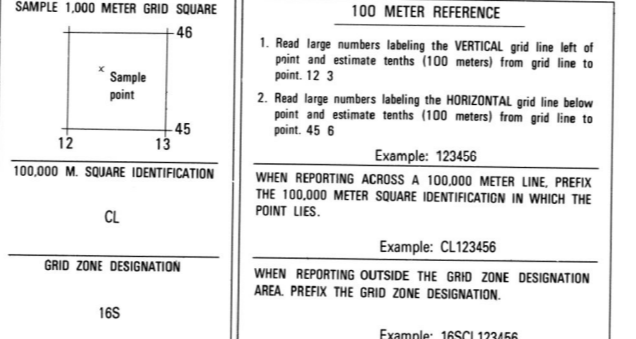

- LEGEND**
- CAUTION: ALL TELEPHONE AND ELECTRIC SERVICE LINES ARE NOT SHOWN.  
A LANE ON THIS MAP IS CONSIDERED TO BE 2.5 METERS WIDE.  
IN DEVELOPED AREAS ONLY THROUGH ROADS ARE CLASSIFIED.  
THERE MAY BE PRIVATE ENCLOSURES WITHIN THE BOUNDARIES OF THE NATIONAL OR STATE RESERVATIONS SHOWN ON THIS MAP.
- ROADS: Divided highway with median strip, Primary, all weather, hard surface, Light duty, all weather, hard or improved surface, Fair or dry weather, unimproved surface, Trail
  - RAILROADS: Standard gauge (1.41m - 4'8 1/2"), Single track, Multiple track, Nonoperating, Railroad station (Location known, Location unknown), Car line
  - BRIDGE: Railroad bridge, Tunnel, Highway, Railroad
  - BOUNDARIES: State, territory, County, parish, Civil township, town, Incorporated city, village, town, Reservation National, State, Military
  - Power transmission line, Buildings, Churches, School, Power substation, Windmill, Watermill, Well, Tank, Mine shaft, Open pit mine or quarry, Horizontal central station, Bench mark, monument, Bench mark, non-monumented, Spot elevations in meters, Levees, river, dike, Bluffs, cliffs, Woodland, Scattered trees, scrub, Vineyard, Orchard, plantation, Intermittent lake, Dam, Earthen, Masonry, Stream, Perennial, Intermittent, Marsh, swamp, Small falls, Large falls, Small rapids, Large rapids

BOUNDARIES ADJOINING SHEETS

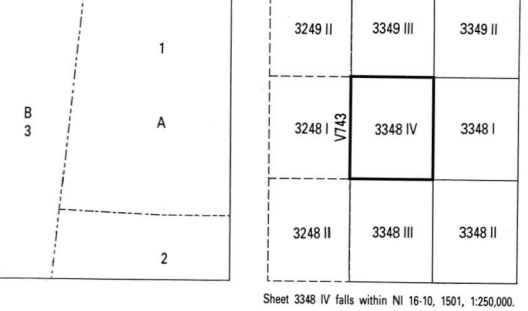

THIS MAP IS RED-LIGHT READABLE

SLOPE GUIDE

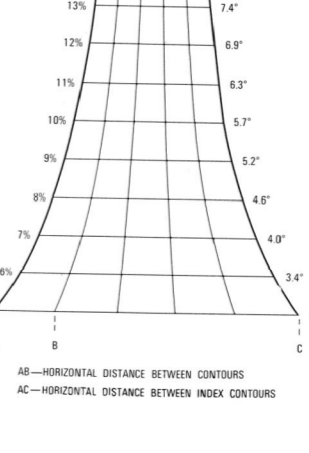

ELEVATION GUIDE

