

Prepared by the U.S. Geological Survey for publication by the National Imagery and Mapping Agency.

MAP INFORMATION AS OF 1993

LEGEND

CAUTION: ALL TELEPHONE AND ELECTRIC SERVICE LINES ARE NOT SHOWN.
A LANE ON THIS MAP IS CONSIDERED TO BE 25 METERS WIDE.
IN DEVELOPED AREAS ONLY THROUGH ROADS ARE CLASSIFIED.
THERE MAY BE PRIVATE INHOLDINGS WITHIN THE BOUNDARIES OF THE NATIONAL OR STATE RESERVATIONS SHOWN ON THIS MAP.

- ROADS**
- Divided highway with median strip
- Primary, all weather, hard surface
- Secondary, all weather, hard surface
- Light duty, all weather, hard or improved surface
- Fair or dry weather, unimproved surface
- Trail
- Route markers: Interstate, Federal, State
- RAILROADS** (Standard gauge 1.43m - 4'8 1/2")
- Single track
- Multiple track
- Nonoperating
- Railroad station: Location known; Location unknown
- Can line
- Railroad bridge
- Tunnel: Highway, Railroad
- BOUNDARIES**
- National, with monument
- State, territory
- County, parish
- Civil township, town
- Incorporated city, village, town
- Reservation: National, State, Military
- Buildings**
- Structures
- Church, School
- Power substation
- Windmill, Watermill
- Well, Tank
- Open pit mine or quarry
- Horizontal control station
- Bench mark, monument
- Bench mark, non-monumented
- Spot elevations in meters
- Levees, rims, dikes
- Railtie, dikes
- Woodland**
- Scattered trees, Scrub
- Vineyard; Orchard, plantation
- Intermittent lake: Dam; Earth; Masonry
- Stream: Perennial; Intermittent
- Marsh, swamp
- Small falls, Large falls
- Small rapids; Large rapids

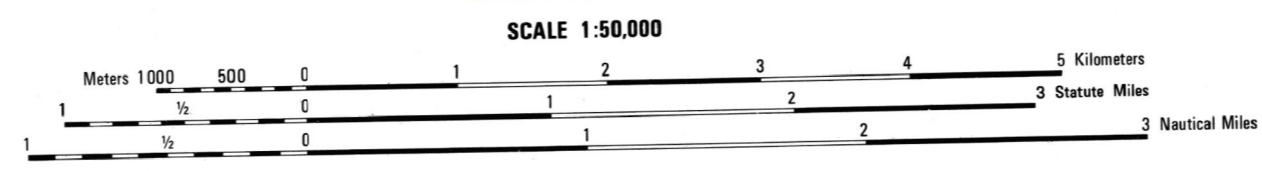

ELEVATIONS IN METERS

CONTOUR INTERVAL 10 METERS

ELLIPSOID: WORLD GEODETIC SYSTEM 1984
 GEODETIC REFERENCE SYSTEM 1980
 GRID: 1,000-METER UTM ZONE 17 (BLACK NUMBERED LINES)
 5,000-METER STATE GRID TICKS, NORTH CAROLINA
 PROJECTION: TRANSVERSE MERCATOR
 VERTICAL DATUM: NATIONAL GEODETIC SYSTEM 1929
 HORIZONTAL DATUM: WORLD GEODETIC SYSTEM 1984/
 NORTH AMERICAN DATUM OF 1983
 CONTROL BY: U.S. GEODetic AND NONGEOdetic
 PREPARED BY: U.S. GEOLOGICAL SURVEY

FOR SALE BY U.S. GEOLOGICAL SURVEY
 DENVER, COLORADO 80225, OR RESTON, VIRGINIA 20192

CONVERSION GRAPH

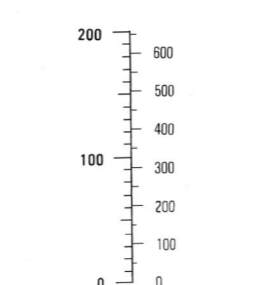

100-METER REFERENCE

1. Road large numbers labeling the VERTICAL grid line to the left of point and estimate tenths (100 meters) from grid line to point. 45.2

2. Road large numbers labeling the HORIZONTAL grid line below point and estimate tenths (100 meters) from grid line to point. 45.6

Example: 125456

WHEN REPORTING ACROSS A 100,000-METER LINE, PREFIX THE 10,000-METER SQUARE IDENTIFICATION IN WHICH THE POINT LIES.

Example: PU125456

WHEN REPORTING ACROSS THE GRID ZONE DESIGNATION AREA, PREFIX THE GRID ZONE DESIGNATION.

Example: 17SPU125456

THIS MAP IS RED-LIGHT READABLE

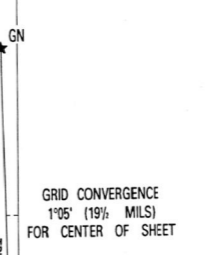

SLOPE GUIDE

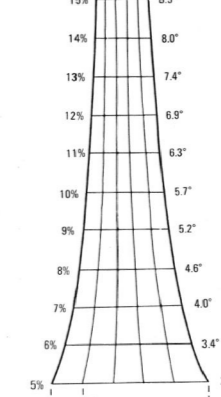

ADJOINING SHEETS

5154 IV	5154 I	5154 V
5154 II	5154 A	5154 III
5153 IV	5153 I	5153 V

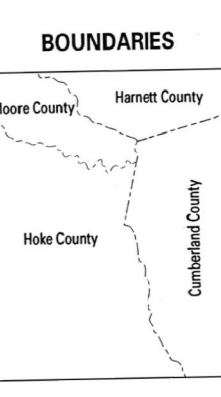

ELEVATION GUIDE

