

GLOSSARY

Bouemud
Canalchannel
Cimcemetery
Corailcoral
Ileisland, isle
Pointepoint
Ravinravine, gully

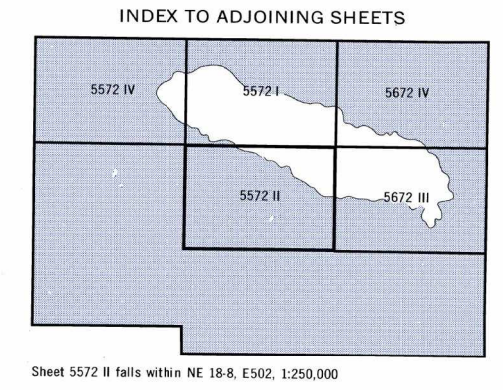

Sheet 5572 II falls within NE 18-8, E362, 1:250,000



E732
Edition 2-AMS

Prepared by the Army Map Service (SX), Corps of Engineers, U.S. Army, Washington, D.C. Copied in 1962 from Haiti, 1:50,000, AMS, Sheet 5572 II, 1958. Original map compiled by photogrammetric methods by Engineers of the Geodetic Service and the Haitian Army under the supervision of the Department of Public Works and with the collaboration of the United States Army Inter American Geodetic Survey. Aerial photography 1956. This map complies with the national standard map accuracy requirements. Marginal data revised 1962.

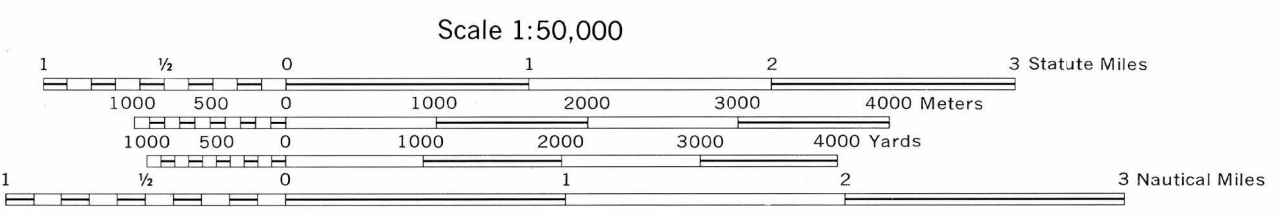

3-63 PRINTED BY ARMY MAP SERVICE, CORPS OF ENGINEERS
Reprinted by NGA 03-04

LEGEND

ROADS	RAILROADS	Water Features	Other Features
All weather, hard surface, two or more lanes wide	Narrow gauge, single track (gauge in meters)	Mangrove	Church, School, Located object
All weather, loose or light surface, two or more lanes wide	Narrow gauge, double or multiple track (gauge in meters)	Salt evaporator	Horizontal control point; Bench mark, monumented
All weather, hard surface, one lane wide	International boundary	Intermittent lake	Spot elevations in meters: Checked, Unchecked
All weather, loose or light surface, one lane wide	Built-up area	Land subject to inundation	Mines: Open pit; Horizontal shaft
Fair or dry weather, loose surface	Church; School; Located object	Canal, aqueduct, conduit	Woods or brushwood; Plantation
Important trail (practicable for jeeps); Track or trail	Route markers: National, Departmental		Swamp; Rice
			Area name

CONTOUR INTERVAL 20 METERS
VERTICAL DATUM: MEAN SEA LEVEL

TRANSVERSE MERCATOR PROJECTION
HORIZONTAL DATUM: 1927 NORTH AMERICAN DATUM

BLACK NUMBERED LINES INDICATE THE 1,000 METER UNIVERSAL TRANSVERSE MERCATOR GRID, ZONE 18, CLARKE 1866 SPHEROID
THE LAST THREE DIGITS OF THE GRID NUMBERS ARE OMITTED

USERS SHOULD REFER CORRECTIONS, ADDITIONS, AND COMMENTS TO THE NGA OPERATIONAL HELP DESK:
1-800-455-0898; COMMERCIAL 314-283-4864; DSN 683-4864; OR WRITE TO: DIRECTOR, NATIONAL GEOSPATIAL-
INTELLIGENCE AGENCY, ATTN: ES, MAIL STOP L-88, 4600 SANGAMORE ROAD, BETHESDA, MD 20816-5003.

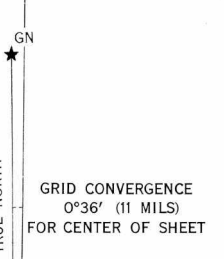

1960 G-M ANGLE
3 1/2° (60 MILLS)

TO CONVERT A MAGNETIC AZIMUTH TO A GRID AZIMUTH
SUBTRACT G-M ANGLE

TO CONVERT A GRID AZIMUTH TO A MAGNETIC AZIMUTH
ADD G-M ANGLE

GRID ZONE DESIGNATION: 18Q	TO GIVE A STANDARD REFERENCE ON THIS SHEET TO NEAREST 100 METERS								
100,000 M. SQUARE IDENTIFICATION	SAMPLE POINT: CHURCH								
<table border="1"> <tr><td>XR</td><td>YR</td></tr> <tr><td>700</td><td></td></tr> </table>	XR	YR	700		<table border="1"> <tr><td>94</td><td>77</td></tr> <tr><td>94</td><td>77</td></tr> </table>	94	77	94	77
XR	YR								
700									
94	77								
94	77								
IGNORE THE SMALLER figures of any grid number; these are for finding the full coordinates. Use ONLY the LARGER figures of the grid number; example: 2065000	SAMPLE REFERENCE: 18Q42778 18Q42778								

POINTE A RAQUETTES, HAITI

NSN 7643014017400
ED. NO 002
NGA Ref No. E732X55722