

6481 SE
1:62,500

UNITED STATES
DEPARTMENT OF THE INTERIOR
GEOLOGICAL SURVEY

CRYSTAL NE QUADRANGLE
NORTH DAKOTA—PEMBINA CO.
7.5 MINUTE SERIES (TOPOGRAPHIC)
NE/4 CRYSTAL 15 QUADRANGLE

6481 IV
1:62,500

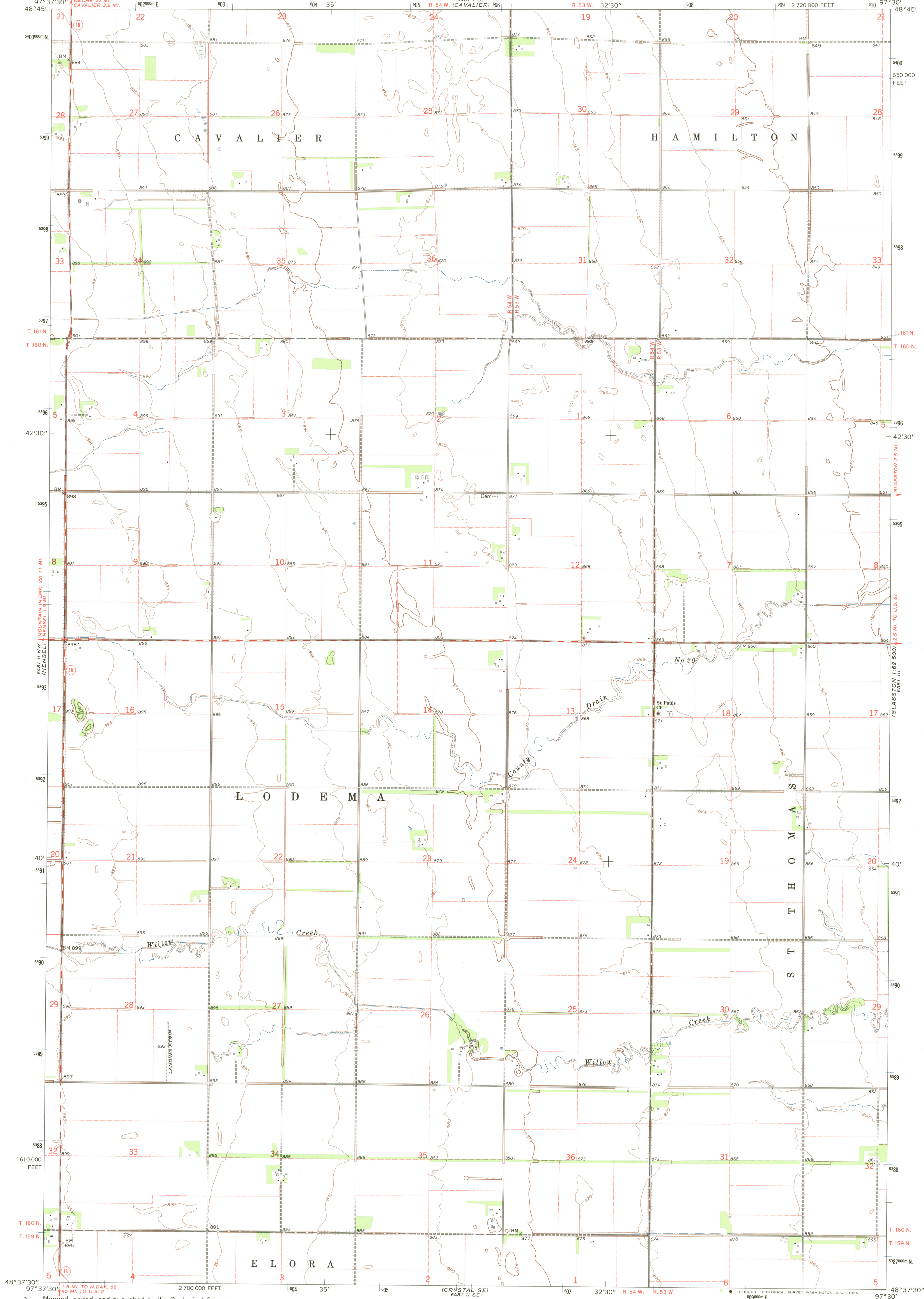

Mapped, edited, and published by the Geological Survey as part of the Department of the Interior program for the development of the Missouri River Basin Control by USGS and USC&GS
Planimetry by photogrammetric methods from aerial photographs taken 1963. Topography by planetable surveys 1964
Polyconic projection. 1927 North American datum 10,000-foot grid based on North Dakota coordinate system, north zone 1000-meter Universal Transverse Mercator grid ticks, zone 14, shown in blue
Fine red dashed lines indicate selected fence and field lines where generally visible on aerial photographs. This information is unchecked

UTM GRID AND 1964 MAGNETIC NORTH DECLINATION AT CENTER OF SHEET

1:05' 19 MILLS

SCALE 1:24,000

CONTOUR INTERVAL 5 FEET
DATUM IS MEAN SEA LEVEL

1 MILE

0 1000 2000 3000 4000 5000 6000 7000 FEET

0 1 2 3 4 5 6 KILOMETER

THIS MAP COMPLIES WITH NATIONAL MAP ACCURACY STANDARDS
FOR SALE BY U.S. GEOLOGICAL SURVEY, DENVER, COLORADO 80225 OR WASHINGTON, D. C. 20242
AND BY THE STATE WATER COMMISSION, BISMARCK, NORTH DAKOTA
A FOLDER DESCRIBING TOPOGRAPHIC MAPS AND SYMBOLS IS AVAILABLE ON REQUEST

ROAD CLASSIFICATION

Medium-duty — Light-duty —
Unimproved dirt — State Route

CRYSTAL NE, N. DAK.
NE/4 CRYSTAL 15 QUADRANGLE
N4837.5—W9730/7.5

1964

AMS 6481 II NE—SERIES V871