

UNITED STATES
DEPARTMENT OF THE INTERIOR
GEOLOGICAL SURVEY

MOUNT SUNFLOWER QUADRANGLE
COLORADO-KANSAS
7.5 MINUTE SERIES (TOPOGRAPHIC)

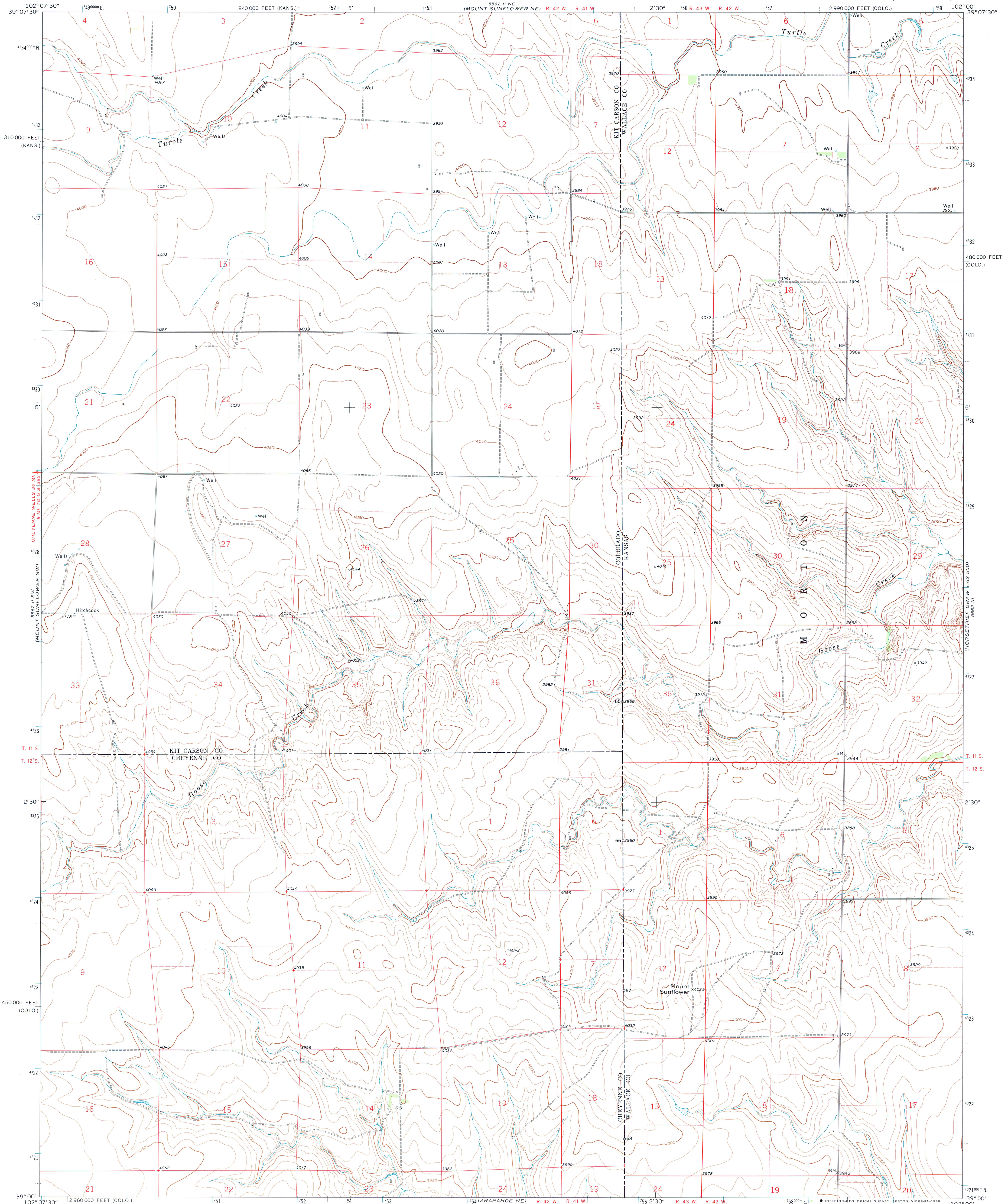

Mapped, edited, and published by the Geological Survey
Control by USGS and USC&GS
Topography by photogrammetric methods from aerial
photographs taken 1968. Field checked 1969
Polyconic projection. 1927 North American datum
10,000-foot grids based on Colorado coordinate system,
central zone, and Kansas coordinate system, north zone
1000-meter Universal Transverse Mercator grid ticks,
zone 13, shown in blue
Fine red dashed lines indicate selected fence lines
Land lines, in part, are based on cultural development
and are not reflected in the original land survey
Certain land lines are omitted because of insufficient data

Map photoinspected 1980
No major culture or drainage changes observed

SCALE 1:24,000
CONTOUR INTERVAL 10 FEET
DATUM IS MEAN SEA LEVEL

THIS MAP COMPLIES WITH NATIONAL MAP ACCURACY STANDARDS
FOR SALE BY U. S. GEOLOGICAL SURVEY, DENVER, COLORADO 80225, OR RESTON, VIRGINIA 22092
AND BY THE STATE GEOLOGICAL SURVEY, LAWRENCE, KANSAS 66044
A FOLDER DESCRIBING TOPOGRAPHIC MAPS AND SYMBOLS IS AVAILABLE ON REQUEST

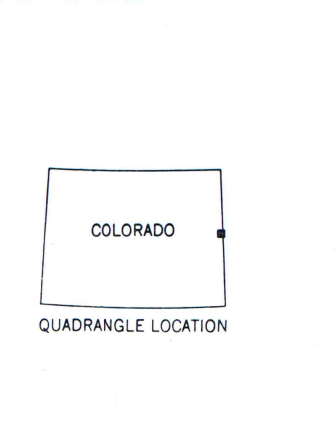

ROAD CLASSIFICATION
Light-duty road, all weather, Unimproved road, fair or dry improved surface weather

MOUNT SUNFLOWER, COLO.-KANS.
N 3900-W10200/7.5
1969
PHOTOINSPECTED 1980
AMS 5562 II SE-SERIES V877

(MOUNT SUNFLOWER NW)
5562 II NW

5562 II NE
HORSETHIEF DRAW
1:62,500

(HORSETHIEF DRAW 1:62,500)
WESKAN 1:62,500