

UNITED STATES
DEPARTMENT OF THE INTERIOR
GEOLOGICAL SURVEY

SEVENMILE PLAZA QUADRANGLE
COLORADO
7.5 MINUTE SERIES (TOPOGRAPHIC)

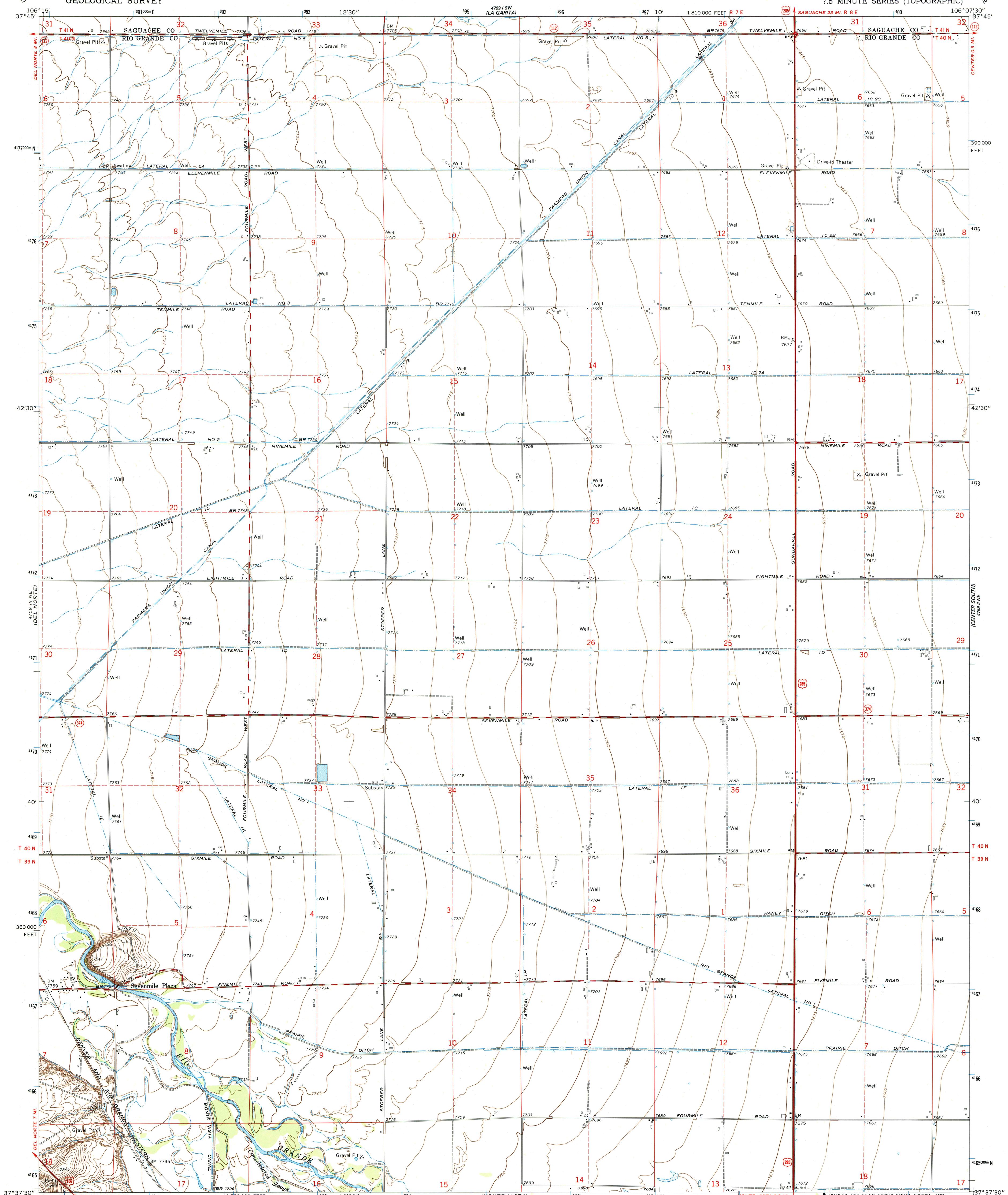

Mapped, edited, and published by the Geological Survey in cooperation with State of Colorado agencies in cooperation with USGS, USC&GS, and U. S. Forest Service. Planimetry by photogrammetric methods from aerial photographs taken 1960. Topography by planetable surveys 1964. Polyconic projection. 1927 North American Datum 10,000-foot grid based on Colorado coordinate system, south zone. 1000-meter Universal Transverse Mercator grid ticks, zone 13, shown in blue. Fine red dashed lines indicate selected fence lines. To place on the predicted North American Datum 1983 move the projection lines 3 meters north and 51 meters east as shown by dashed corner ticks.

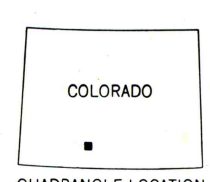
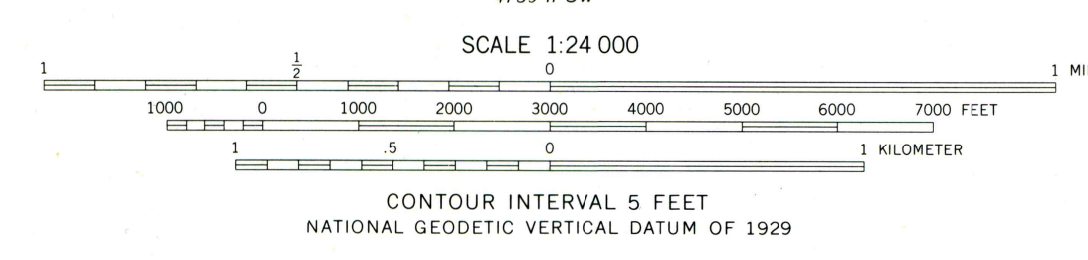
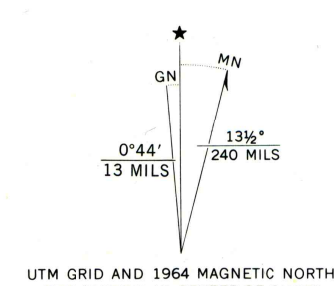

ROAD CLASSIFICATION

Heavy-duty	Light-duty
Medium-duty	Unimproved dirt
U.S. Route	State Route

THIS MAP COMPLIES WITH NATIONAL MAP ACCURACY STANDARDS FOR SALE BY U. S. GEOLOGICAL SURVEY, DENVER, COLORADO 80225, OR RESTON, VIRGINIA 22092. A FOLDER DESCRIBING TOPOGRAPHIC MAPS AND SYMBOLS IS AVAILABLE ON REQUEST.

SEVENMILE PLAZA, COLO.
37106-F2-TF-024

1964
DMA 4759 II NW-SERIES V877