

Mapped, edited, and published by the Geological Survey
 Control by USGS and NOS/NOAA
 Topography by photogrammetric methods from aerial photographs taken 1965. Field checked 1967
 Polyconic projection. 1927 North American Datum
 10,000-foot grid based on Colorado coordinate system, south zone
 1000-meter Universal Transverse Mercator grid ticks, zone 13, shown in blue
 Fine red dashed lines indicate selected fence lines
 Certain land lines are omitted because of insufficient data
 To place on the predicted North American Datum 1983
 move the projection lines 4 meters north and
 56 meters east as shown by dashed corner ticks

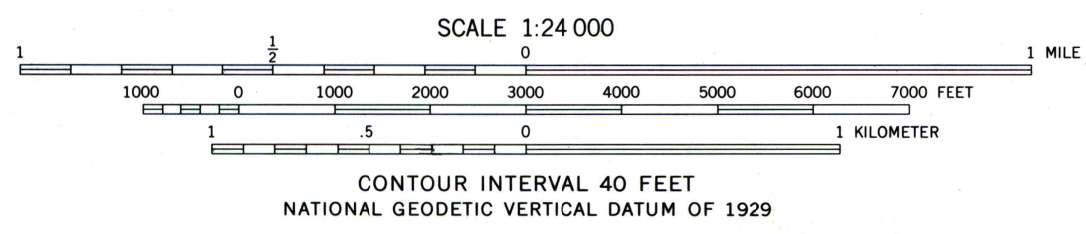
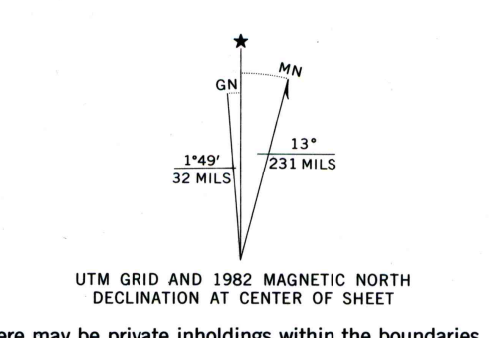

ROAD CLASSIFICATION
 Secondary highway, all weather. Light-duty road, all weather, improved surface.
 Unimproved road, fair or dry weather.
 State Route
 Primary highway, all weather, hard surface.

THIS MAP COMPLIES WITH NATIONAL MAP ACCURACY STANDARDS
 FOR SALE BY U.S. GEOLOGICAL SURVEY, P.O. BOX 25286, DENVER, COLORADO 80225
 A FOLDER DESCRIBING TOPOGRAPHIC MAPS AND SYMBOLS IS AVAILABLE ON REQUEST

Revisions shown in purple compiled from aerial photographs taken 1978 and other source data. This information not field checked. Map edited 1982

QUADRANGLE LOCATION
 COLORADO

SAMS, COLO.
 38107-A8-TF-024
 1967
 PHOTOREVISED 1982
 DMA 4460 III SW—SERIES V877

ISSN 0-607-12760-5
 9 780607 127605