

UNITED STATES
DEPARTMENT OF THE INTERIOR
GEOLOGICAL SURVEY

FREMONT BUTTE QUADRANGLE
COLORADO—WASHINGTON CO.
7.5 MINUTE SERIES (TOPOGRAPHIC)

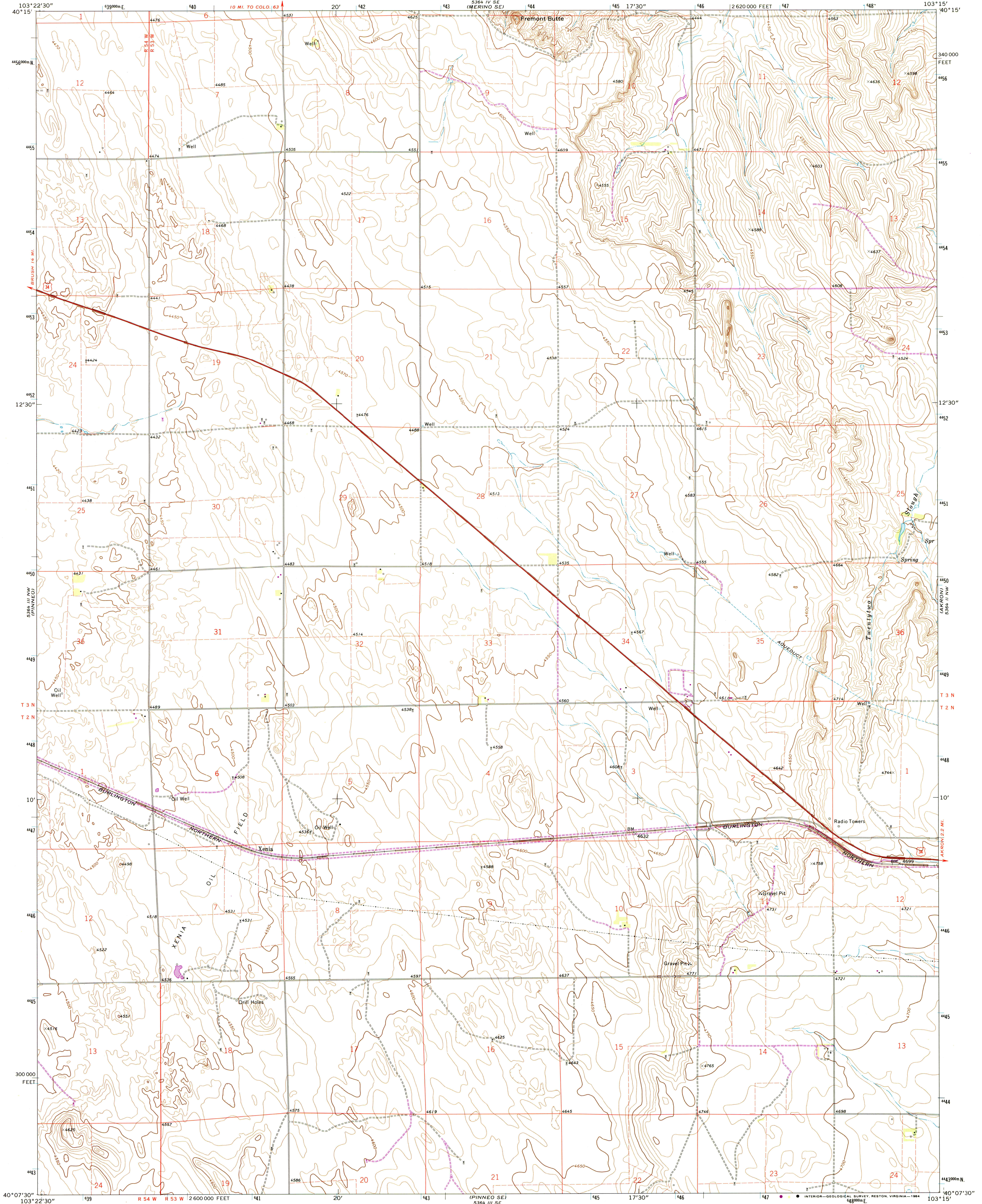

Mapped, edited, and published by the Geological Survey
Control by USGS and NOS/NOAA
Topography by photogrammetric methods from aerial photographs taken 1972. Field checked 1973.
Projection and 10,000-foot grid ticks: Colorado coordinate system, north zone (Lambert conformal conic).
1000-meter Universal Transverse Mercator grid ticks, zone 13, shown in blue.
1927 North American Datum
To place on the predicted North American Datum 1983 move the projection lines 5 meters north and 43 meters east as shown by dashed corner ticks.
Fine red dashed lines indicate selected fence lines.
Land lines in part are based on cultural development and are not reflected in the original land survey.

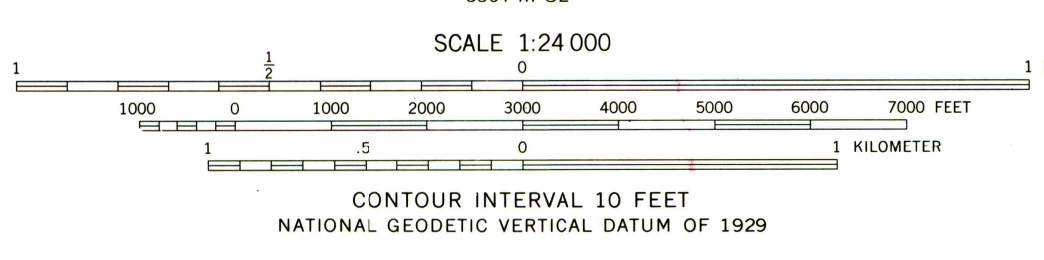
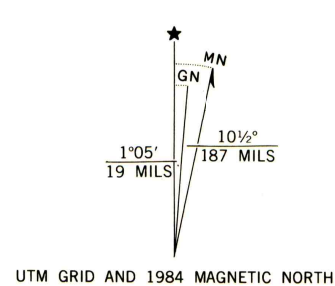

ROAD CLASSIFICATION

Primary highway, hard surface	Light-duty road, hard or improved surface
Secondary highway, hard surface	Unimproved road
○ Interstate Route	○ U. S. Route
	○ State Route

QUADRANGLE LOCATION

THIS MAP COMPLIES WITH NATIONAL MAP ACCURACY STANDARDS
FOR SALE BY U.S. GEOLOGICAL SURVEY, DENVER, COLORADO 80225, OR RESTON, VIRGINIA 22092
A FOLDER DESCRIBING TOPOGRAPHIC MAPS AND SYMBOLS IS AVAILABLE ON REQUEST

Revisions shown in purple and woodland compiled from aerial photographs taken 1982 and other sources
This information not field checked. Map edited 1984

FREMONT BUTTE, COLO.
40103-83-TF-024
1973
PHOTOREVISED 1984
DMA 5384 III NE—SERIES V877